

Adjustments

⚠ Warning!

Before riding, always make sure that the basic settings made by Öhlins are according to recommended Set-up Data. Read about adjustments and setting up in the Öhlins Owner's Manual before you make any adjustments. Contact an Öhlins dealer if you have any questions about setting up the steering damper.

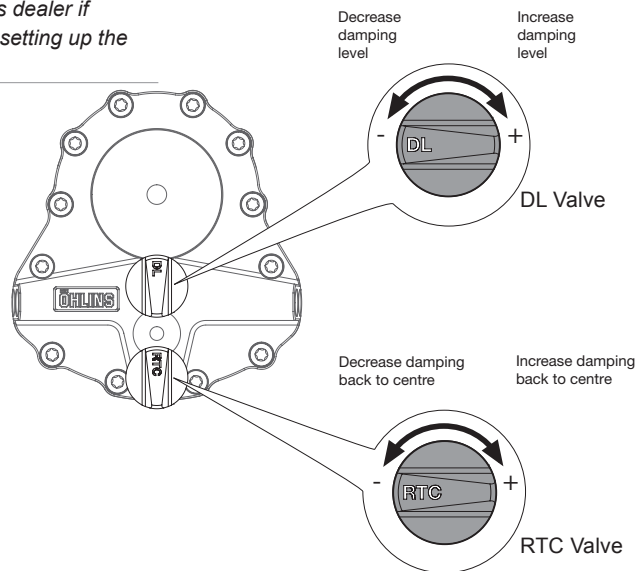

Set-up Data

Recommended set-up

Motocross:

DL Valve	12 clicks
RTC Valve	6 clicks

Enduro:

DL Valve	12 clicks
RTC Valve	8 clicks

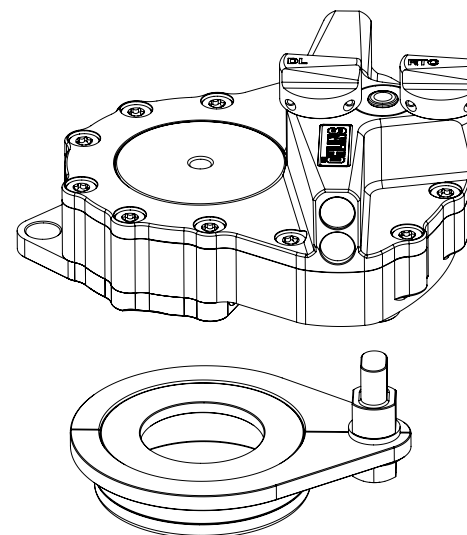

👁 Note!

Before installing this product, check the contents of the kit. If anything is missing, please contact an Öhlins dealer.

Kit Contents

	Part No.	Pcs.
Steering damper	SD533	1
Bracket	15550-55	1
Washer 6.4/12/1.5	00153-04	1
Pin	15549-01	1
Screw M6x12	00432-11	1
Washer 6.4/12/1.5	00153-04	1
Sticker	00192-01	2
Screw M4x16	00382-31	2
Nut M6	00437-05	1
X-ring 44.17x1.78	01027-09	1
Screw M6x16	01046-01	1
Screw M6x35	01046-06	1
Plastic folder	01202-01	1
Sleeve 6x8x6.3	01444-02	1
Sleeve 6x8x11.5	02238-01	1
Tool	04970-01	1
Screw M8x35	05404-05	1
Owner's Manual	07270-06	1
Plug	15507-02	1
Mounting block	15532-01	1
Seal washer 47.3x28.8	15551-05	1
Spacer 20x35x3	15555-02	2
Cover	15558-03	1

👁 Note!

Please note that during storage and transportation, especially at high ambient temperature, some of the oil and grease used for assembly may leak and stain the packaging. This is in no way detrimental to the product, wipe off the excessive oil/grease with a cloth.

⚠ Warning!

Before installing this product, read the Öhlins Owner's Manual. The steering damper is an important part of your vehicle and will affect the stability.

👁 Öhlins products are subject to continuous improvement and development, therefore, although these instructions include the most up-to-date information available at the time of printing, minor updates may occur.

To find the latest information contact your Öhlins distributor. Please consult your Öhlins dealer if you have any questions regarding the contents in this document.

Part no. SD533_3
Issued 2012-03-07



© Öhlins Racing AB. All rights reserved. Any reprinting or unauthorized use without the written permission of Öhlins Racing AB is prohibited.

Öhlins Racing AB
Box 722
S-194 27 Upplands Väsby, Sweden
Phone +46 8 590 025 00
fax +46 8 590 025 80



www.ohlins.com

Steering Damper for KTM EXC/SX, Husaberg FE/TE

SD 533

Mounting Instructions



How to install

⚠ Warning!

It is advisable to have an Öhlins dealer install the steering damper.

When installing, consult your Vehicle Service Manual.

⚠ Warning!

Make sure the vehicle is securely supported so that it will not tip.



1

Put the motorcycle on a workstand. Remove the front fork, the triple clamps, the original upper steering stem nut and washer (you will not need these parts to install the Öhlins steering damper).

2

In order to prevent a possible difficult removal and remounting a premounting and measurement is performed. Place the fork in a vice and mount the provided bracket, the triple clamps and the steering damper.

2

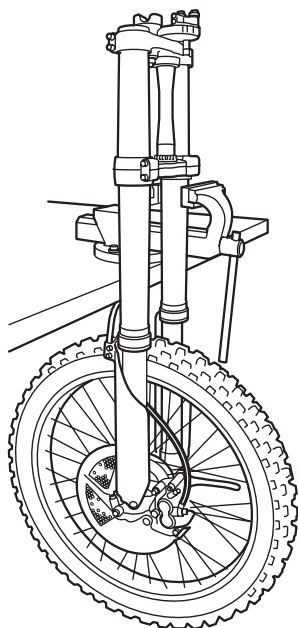

3

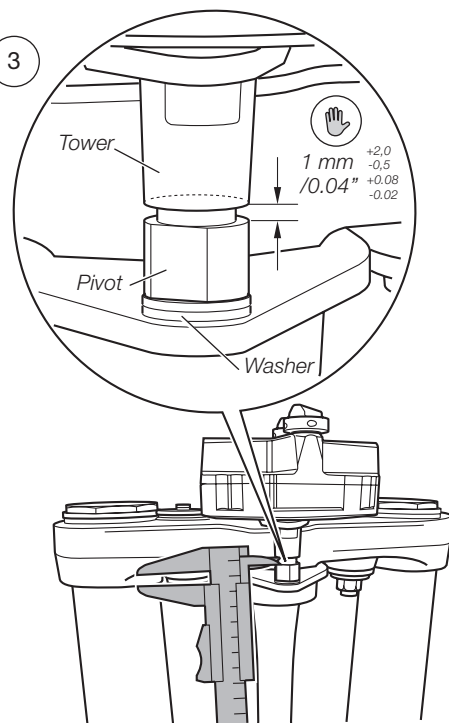

3

Measure the distance between the top of the tower and the pivot with a slide gauge. This is just a first rough estimation of the distance, see figure.

⚠ Caution!

The gap between the tower and the pivot must be $1^{+2}_{-0.5}$ mm when the installation is finished. The tower must never touch the lower part of the pivot at any position between the steering stops. There must always be a visible gap.

If the distance is too large use washers between the pivot and the bracket to achieve the correct distance.

Note!

The pins at the bottom of the steering damper has at this point not being pressed into the triple clamp which make the distance about 1 mm larger.

16

Tighten the slit screw to 20 Nm.

👁 Note!

If the original screw interferes with the damper, replace the original screw with screw (05404-05) provided in this kit.

17

Use a torque wrench and tool 04970 01 (provided in this kit). Tighten the upper steering stem nut temporarily to 55 Nm. This will press down the pins into the triple clamp.

👁 Note!

All threads on the upper steering stem nut will not be used, that is correct as long as the nut is tightened properly.

Rec: Minimum 4 [four] full turns engagement.

18

First loosen the upper steering stem nut, then the slit screw. Retighten the upper steering stem nut to 10 Nm. Tighten the slit screw to 20 Nm. Continue tightening the upper steering stem nut to 20 Nm.

19

Make sure that the steering stops work properly. Tighten the upper triple clamp bolt to recommended tightening torque.

⚠ Caution!

The damper should not act as a steering stop since that can damage and possibly break the steering damper.

20

Reinstall all removed parts in reversed order.

21

Install the centre lid by pressing it into the hex opening. Use an M6 screw and a pair of pliers if you must remove the lid.

16

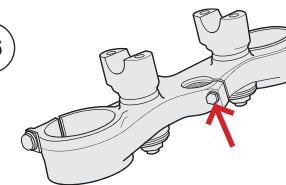

17

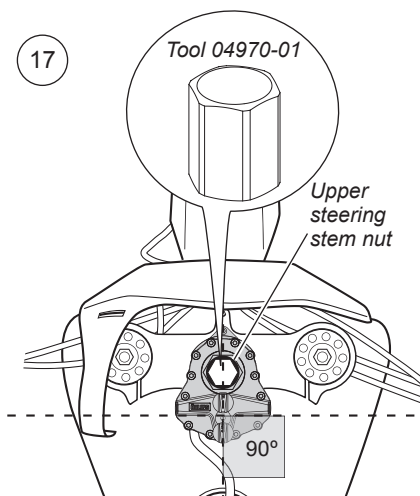

21

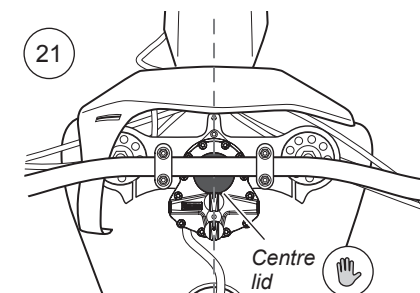

⚠ Caution!

Do not try to remove the lid with a screwdriver, the lid may break!

How to install

👁 Note!

There are 3 different procedures (a, b and c) for steps 10-13 depending on vehicle model. Make sure to follow the correct instructions.

Type c

HUSABERG FE/TE 2010-2011

👁 Caution!

It is of critical importance that the damper is mounted in a straight line according to the figure. The two small pins will be pressed down into the upper triple clamp when the upper steering stem nut provided is tightened.

12c

Mount the damper in a straight line and tighten slightly. Use an 8 mm drill by hand to indicate the position of the hole.

13c

Remove the damper and make a punch mark.

14c

Drill a 5 mm hole. Use a thread tap (M6x1) to make the thread.

👁 Note!

We recommend to use a thread tap when making the hole. If you do not have a thread tap; drill a 6,5mm hole through the triple clamp.

15c

Mount the damper. Do not tighten yet. Use provided screw (01046-01), sleeve (01444-02) in the threaded hole.

Use thread locking fluid
Tightening torque 15 Nm

For 6,5 mm hole;

Mount the screw (01046-06), sleeve (01444-02) above the triple clamp and sleeve (02238-01) below the triple clamp. Nut (00437-05)

Tightening torque 15 Nm

→ Go to step 16

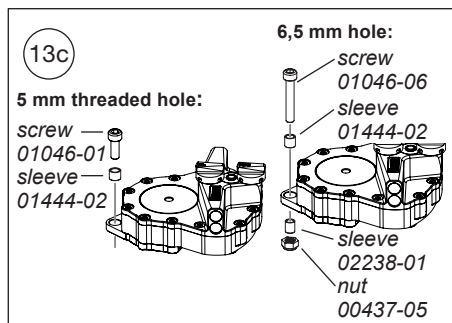
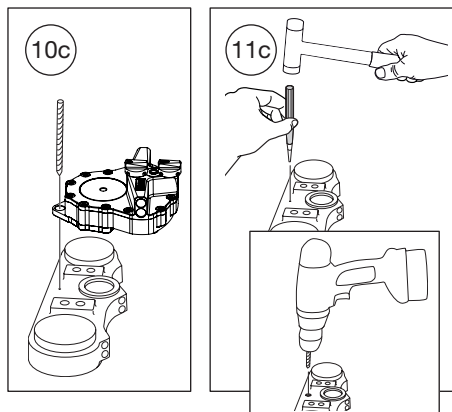
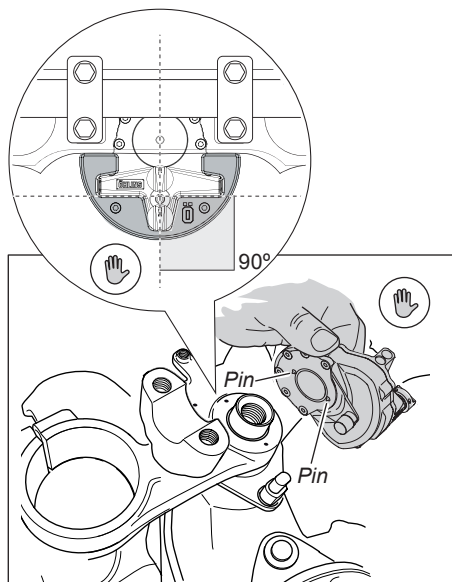

How to install

4

Remove the steering damper and the triple clamps.

6

Remove the outer ring of the upper steering head bearing. Remove the original dust seal on the bearing, if any.

7

Replace the outer ring with the bracket provided. The bracket must be press fitted into the steering head, use proper tools.

👁 Caution!

The bracket must be installed in a straight line. Follow the sight line on the bracket, see figure.

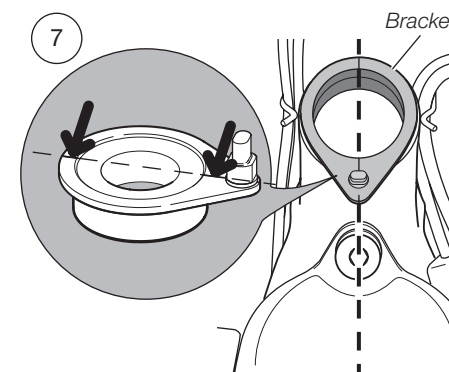

8

Apply some grease on the x-ring and mount it into the groove on the seal washer (provided).

👁 Caution!

When mounting, make sure not to twist the x-ring.

9

Put grease and install the original steering head bearing and the seal washer. Flat side of the seal washer facing up. The provided seal washer replaces the original dust seal, if any.

10

Put some grease inside the tower to avoid the noise that otherwise can occur.

9

Seal washer
X-ring

Steering head bearing

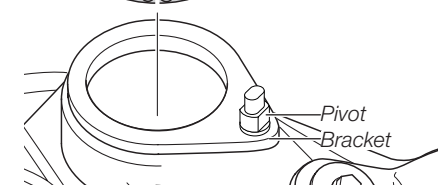

👁 Note!

On models with adjustable offset you may need to adjust the pivot offset position, use tread lock and tighten the screw to 15 Nm.

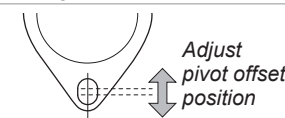

11

Reinstall the triple clamps and fork legs. Tighten the bolts on the lower triple clamp to recommended tightening torque according to your Vehicle Service Manual.

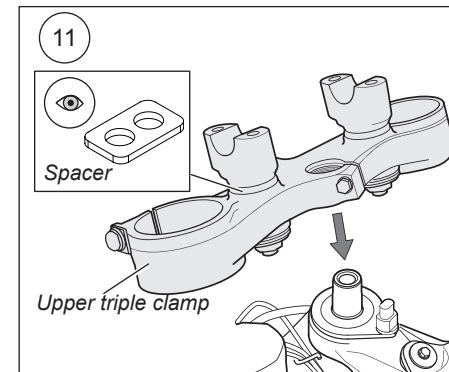

👁 Note!

If the handlebar interferes with the steering damper, use the washers (provided in this kit) between the bottom part of the handle bar clamps and the upper triple clamp.

⚠ Warning!

If the throttle cables interfere with the steering damper it may restrict handlebar operation. Rubbing on the steering damper body can cause excessive wear on the throttle cables.

To prevent this, install cover (15558-03) and two screws (00382-31) (provided in the kit).

Tightening torque 4 Nm

⚠ Caution!

Do not remove any other screws than the two indicated.

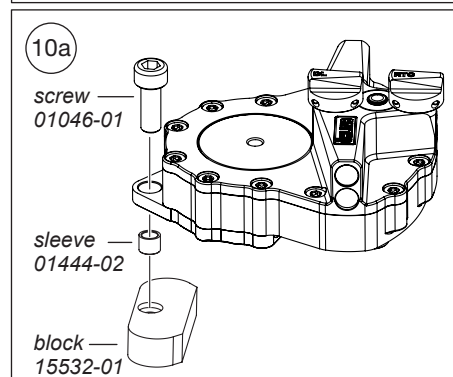
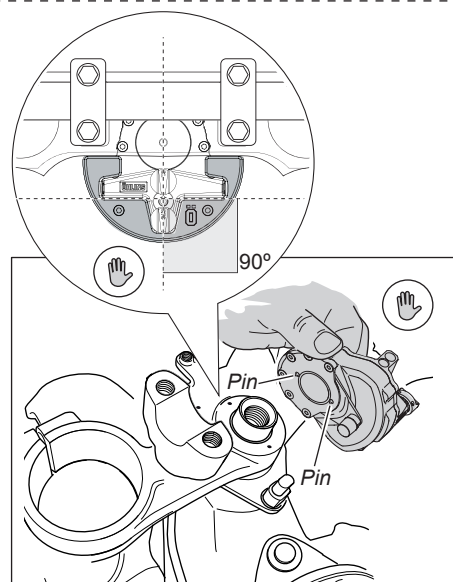
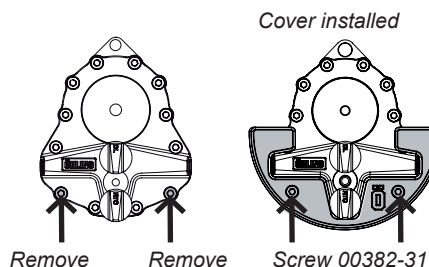

Type a

KTM SX 2010-2012

⚠ Caution!

It is of critical importance that the damper is mounted in a straight line according to the figure. The two small pins will be pressed down into the upper triple clamp when the upper steering stem nut provided is tightened.

12a

Install block with screw and sleeve according to figure.

Use thread locking fluid
Tightening torque 15 Nm

13a

Mount the damper. Do not tighten yet.

→ Go to step 16

👁 Note!

There are 3 different procedures (a, b and c) for steps 10-13 depending on vehicle model. Make sure to follow the correct instructions.

Type b

KTM EXC 2008-2012 SX 2008-2009

⚠ Caution!

It is of critical importance that the damper is mounted in a straight line according to the figure. The two small pins will be pressed down into the upper triple clamp when the upper steering stem nut provided is tightened.

12b

Mount the damper in a straight line and tighten slightly. Use an 8 mm drill to indicate the position of the hole by hand.

13b

Remove the damper and make a punch mark.

14b

Drill a 5 mm hole. Use a thread tap (M6x1) to make the thread.

👁 Note!

We recommend to use a thread tap when making the hole. If you do not have a thread tap; drill a 6,5 mm hole through the triple clamp.

15b

Mount the damper. Do not tighten yet. Use provided screw (01046-06), sleeve (02238-01) in the threaded hole.

Use thread locking fluid
Tightening torque 15 Nm

For 6,5mm hole;

Mount screw (01046-06), sleeve (02238-01) and the nut (00437-05).

Tightening torque 15 Nm

→ Go to step 16

